

SHORT STROKE (S)

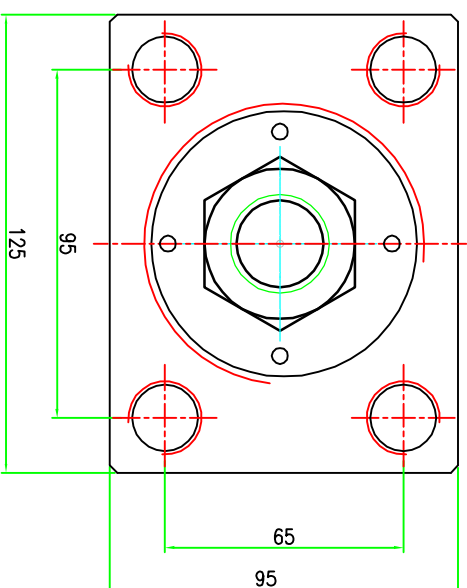
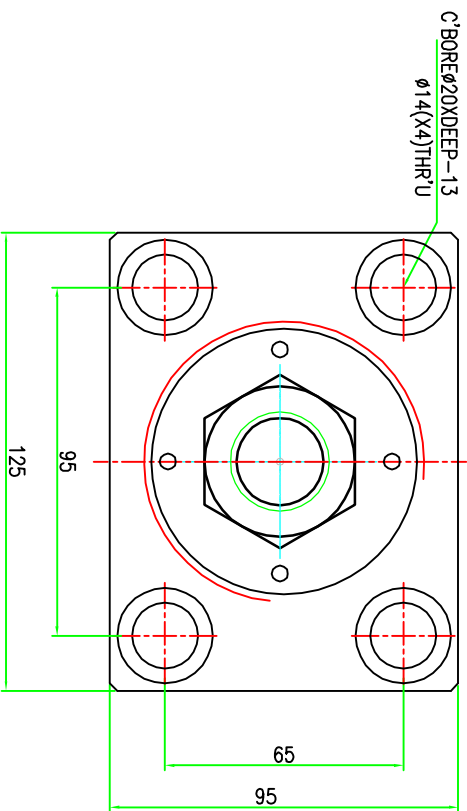
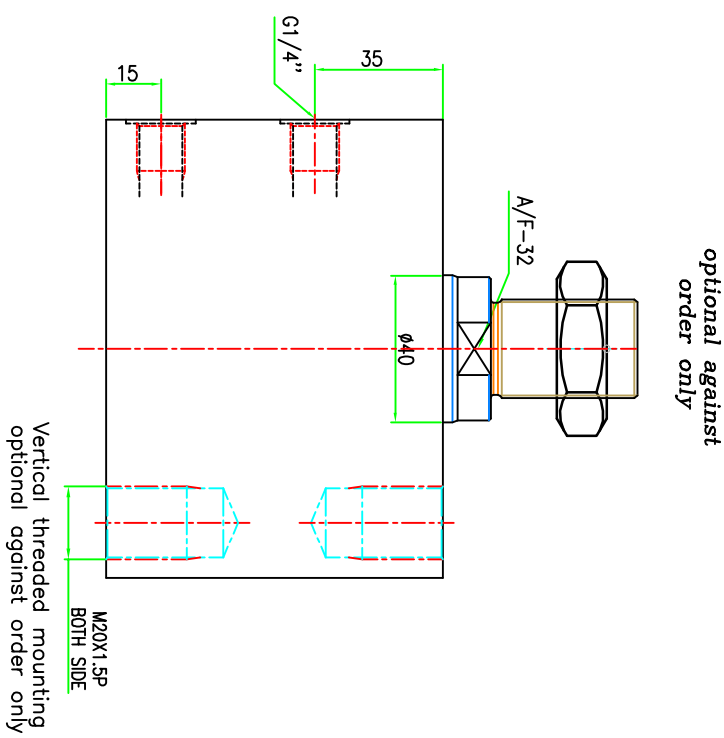
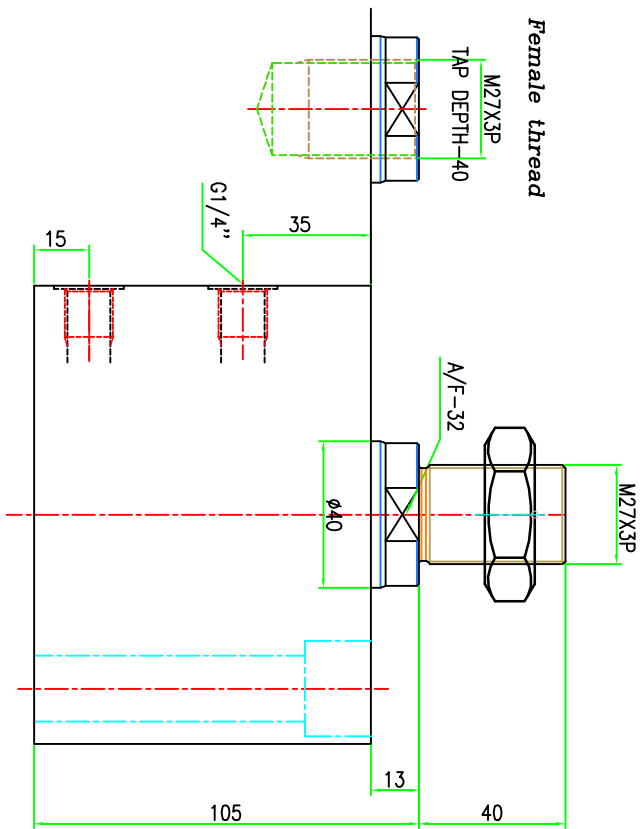

**Model NO-Male thread-A31311**  
**Female thread-A31312**

**Specification:-**  
 Type : Double acting hydraulic cylinder.  
 Bore dia = 63 mm, rod dia = 40 mm  
 Stroke = 20 mm  
 Operating pressure : max 250 bar/min 10 bar  
 Medium :Hydraulic oil (servo system HLP46/HLP68)

optional against order only

Vertical threaded mounting optional against order only

REVISION				
ZONE	REV	FROM	TO	DATE

SURFACE FINISH		▽▽▽	▽▽	▽▽	▽▽	▽	~
Ra value μm		0.025	0.05	0.1	0.2	0.4	0.8
LINEAR - LENGTH OR DIAMETER		0-5	6-30	30-120	120-315	315-1000	1000-2000
ANGULAR-LENGTH IN MM OF SHORT SIDE OF ∠		UPTO 6	6-30	30-120	120-400	400-1000	1000-2000
SCALE:		1:1					
TITLE		BLOCK CYLINDER DOUBLE ACTING					
MATERIAL:		XXX					
SHEET NO:		1 OF 1					

- 1.0 GENERAL
- 1.1 ALL DIMENSIONS ARE IN MM.
- 1.2 DO NOT SCALE THE DRG.IF IN DOUBT ASK.
- 1.3 SUBJECT TO CHANGE FOR IMPROVEMENT.

DESIGN	TIRUMAL	DATE	22.08.08	MACHINE TYPE	
DRAWN	TIRUMAL	DATE	22.08.08	CUSTOMER:	
CHECKED					
APPROVED					

**QUICLOC**  
**PVT LTD**  
**B'lore - 70**